



CHUCK

2-Jaw Mega-Long Stroke Chuck

MLT series

Exceptionally long Jaw stroke

Best suited for gripping irregular shaped components

*CE correspondence



Standard Chuck

Gripping Example

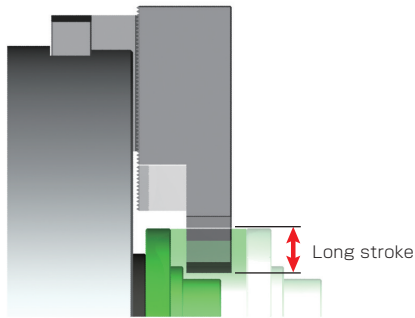

- Suitable for machining of valves.
Common jaw sets can be used due to long stroke.

Gripping Characteristic Graphs

*With standard blank soft top jaw.

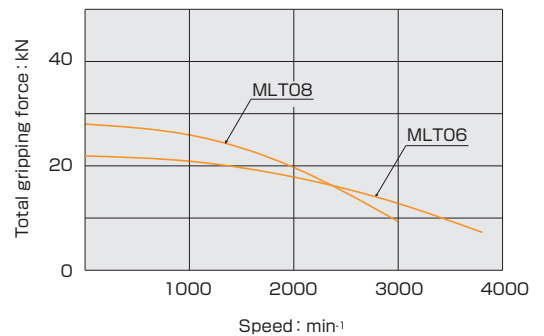

Dimensional Drawings

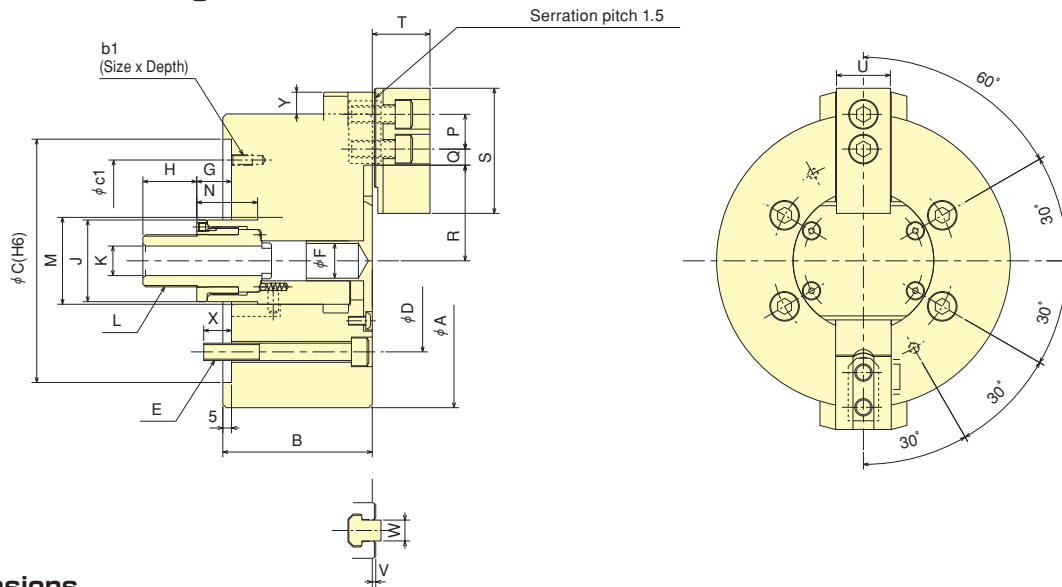

Dimensions

Dimensions	A	B	C	D	E	F	G max.	G min.	H	J	K	L	M	N	P	Q max.	Q min.
Model																	
MLT06	169	86	140	104.8	4-M10	20	40	20	31	47	17	M30×1.5	50	35	20	13.75	9.25
MLT08	215	99	170	133.4	4-M12	20	34	9	34	54	17	M33×1.5	70	29	25	18	12

Dimensions	R max.	R min.	S	T	U	V	W	X	Y max.	b1	c1
Model											
MLT06	55	35	72	33.2	31	2	12	16	12.5	2-M6×12	116
MLT08	65.6	40.6	95	39.2	35	2	14	21	12.1	3-M6×12	150

Specifications

*Gripping dia./gripping range is with standard soft jaws.

Specifications	Gripping range mm		Jaw Stroke (diameter) mm	Plunger Stroke mm	Max. Draw Bar Pull Force kN	Max. Gripping Force kN	Max. Speed min ⁻¹	Net Weight with Soft top jaws kg	Moment of inertia kg·m ²	Matching Cylinder	Max. pressure MPa	Matching Soft top jaw
Model	Max.	Min.										
MLT06	169	37	40	20	24	21.9	3800	13.7	0.054	Y1225R/RE47	2.39	SJ06A1T
MLT08	215	38	50	25	30	28	3000	25.7	0.164	Y1530R/RE47	2.13	SJ08A1

*Altering Back Plate enables to change over 3-Jaw Chuck into 2-Jaw Chuck.